

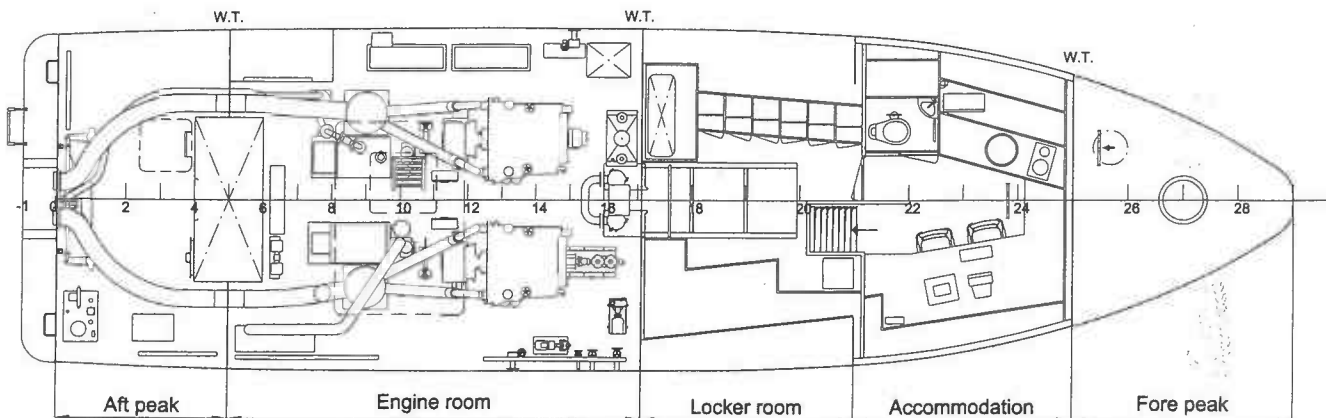

<b>Built</b>	Damen Gorinchem, Damen Stan Patrol 1800
<b>Classification</b>	Bureau Veritas Coastal waters, Dutch ILenT 15 miles offshore.
<b>Dimensions</b>	Length overall 18.80m Beam 5.25m Draft 1.25m
<b>Main Engines</b>	2 x MTU 8V 183 TE92 engines, each 605 bhp at 2300 rpm, driving through ZF gearboxes to fixed pitch (CuAlNi) propellers. (Incl. trolling valves)
<b>Speed</b>	Maximum 22 knots (light ship) Cruising 18 knots
<b>Tank Capacities</b>	Fuel 2.500 liter Fresh Water 220 liter Waste water 350 liter Dirty oil 380 liter
<b>Navigation Aids</b>	Magnetic and GPS compasses, GPS, GMDSS A1, 2 x VHF DSC, radar, electronic chart display, echosounder, Navtex, AIS, autopilot, Epirb, sart.
<b>Seating &amp; Accommodation</b>	Large wheelhouse with seating and several workplaces for survey, VTS etc. aftdeck area with hydraulic crane for efficient cargo transfer., storage areas, WC, shower, galley, climate controlled.
<b>Equipment</b>	Rubber bow fendering and lowered boarding platform with safety railings. Onan silenced keel cooled 13.5 kw generator set, fassi hydraulic crane, fast intervention rib.

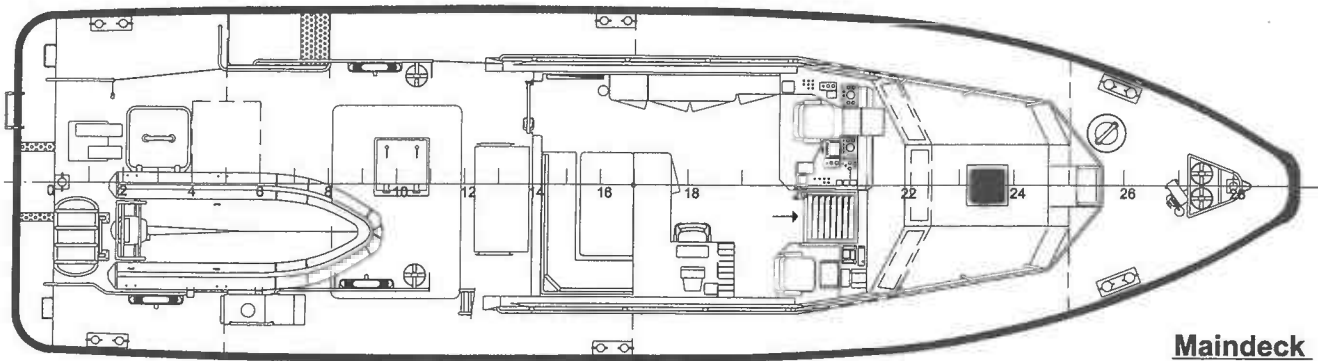
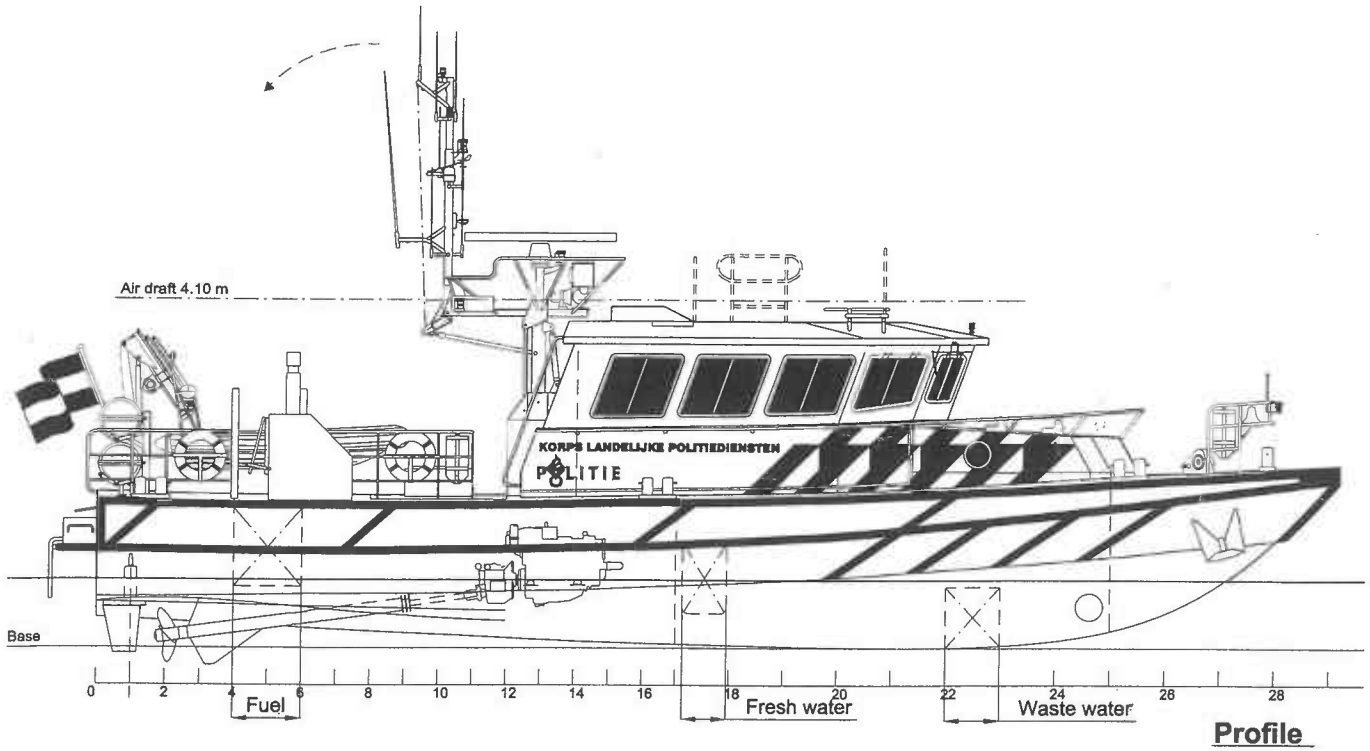

# LUNA<sup>®</sup>

## Damen Stan Patrol 1800

"P 64"



### General

Yard no.	: 548901
Hull material	: aluminium
Superstructure	: aluminium
Year of delivery	: May 2000
Basic functions	: Patrol Boat
Classification	: <b>N.S.I.</b> Coastal Waters upto 15 nm offshore <b>Bureau Veritas</b> I 3/3 E ✳ Special Service / Police Boat Coastal Water Service ● MACH
Flag	: Dutch

### Dimensions

Length o.a.	: 18.80	m
Beam o.a.	: 5.25	m
Depth at sides	: 2.20	m
Draught aft	: 1.25	m

### Tank capacities

Fuel oil	: 2.49	m <sup>3</sup>
Fresh water	: 0.22	m <sup>3</sup>
Waste water	: 0.35	m <sup>3</sup>
Dirty oil	: 0.38	m <sup>3</sup>

### Performances (trials)

Speed	: 21.6 knots
-------	--------------

### Propulsion system

Main engines	: 2x MTU 8V 183 TE92
Total power	: 890 bkW (1210 bhp) at 2300 rpm
Gearboxes	: 2x ZF IRM 350A (incl. trolling valves)
Propellers	: 2x CuAlNi fixed pitch propellers

### Electrical equipment

Generator set	: Onan, MDKAE
Capacity	: 16 kVA, 230V / 400V

### Deck lay-out

Anchor equipment	: 1x 65 kg H.H.P. Pool N + 75m chain
Fendering	: Rubblylene 100 mm
Hydraulic crane	: De Jong lift 1.7 3H 1.7 tm

### Auxiliary systems

Bilge pumps	: SIHI 1x 37 m <sup>3</sup> /hr and 1x 16 m <sup>3</sup> /hr
E.R. ventilation	: 1x 10,000 m <sup>3</sup> /hr
Fire fighting	: FM 200 system engine room
Bow thruster	: Promac, 18kW

### Life saving equipment

Life buoys	: 3
Life jackets/suits	: 6/6
Life rafts	: 2x 6 persons
Dinghy	: Duarry SB-Cat 400
Fire extinguishers	: 2x 5 kg CO <sub>2</sub> , 4x 6 kg dry powder

### Accommodation

Crew	: 3 persons
Noise level (W.H.)	: 64 dB(A)

### Nautical and communication equipment

Searchlight	: 1x 650 Watt 24V, remote controlled
Compass/pilot	: Alphacourse/Alphapilot
Echo sounder	: JRC FF30
VHF	: Skanti VHF 1000 DSC
Radar	: JRC JMA 608
GPS/chart	: JRC BGPS 200/Alpha chart